

INSTRUCTIONS

- 1) The projector in the shipping box is ready for wall (horizontal) mounting.
- 2 and 3) For pole mounting unscrew the 4 screws, remove the top cover and rotate 90° downwards the pole hub.
- 4 and 5) Insert the power cable into the pole hub and through the cable gland until the wiring compartment. Use H05RN-F cable (2 x 2,5mm²) only. If the external cable or cord of this luminaire is damaged, it shall be exclusively replaced by the manufacturer or his service agent or a similar qualified person in order to avoid a hazard.
- 6) Connect the wires to the terminal block respecting the polarity.
- 7) To lock the projector to the desired inclination hold it in the desired position and at the same time close the top cover that will work as a stop. Screw back the 4 screws.
- 8) Tighten the two locking screws (8x20mm) of the pole hub. The projector, in the event of a failure, does not require replacement of any component, LED modules included.

- **Minimum installation height = 4 mt**

- **Maximum installation height = 12 mt**

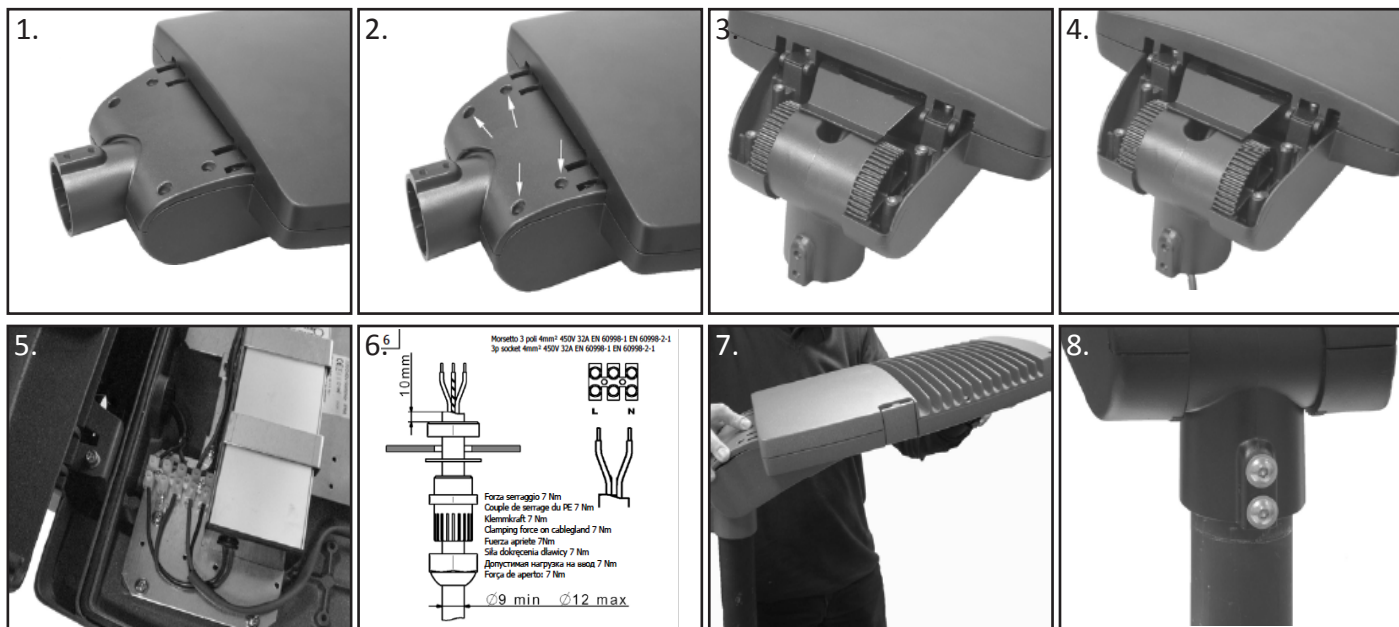

IMPORTANT WARNINGS

Do not install the luminaire in areas without sufficient air circulation. The manufacturer cannot be considered liable for any damage caused by inappropriate use of the luminaire other than its manufactured purpose.

Luminaries must be installed by a qualified registered electrician only. Any misuse of the luminaire when power is activated may cause the risk of an electric shock.

The manufacturer does not accept any responsibility of any issues resulting from the non-compliance of the recommendations included in this instruction document. These instructions are issued as a guide to assist the installer to satisfactory conclusion.

The manufacturer reserves the right to change the design of this product without prior notice.

WASTE DIRECTIVE

The European Directive 2002/96/EC on waste electrical and electronic equipment requires that electric and electronic devices must not be disposed of in the normal household waste. For correct disposal, please use authorized waste disposal facilities or return to the distributor at the date a new lighting fitting is purchased. Lamps, if disposed together with the lighting fitting, should not be broken up as they contain pollutants, which are harmful to the environment. Unauthorized disposal of the foregoing waste material is punishable by law.

